

INSTRUCTION FOR THE MOST DURABLE FOLDABLE VASE IN THE WORLD

THE ART OF FOLDING

A DURABLE DESIGN VASE IN A FEW STEPS

SEE THE WEBSITE HENDRIK.NU FOR THE INSTRUCTIONAL VIDEO

1 TAKE THE UNFOLDED VASE OUT OF THE PACKAGING. ROLL IT OPEN AND LEAVE IT FLAT ON THE TABLE FOR A FEW HOURS, SO THAT THE VASE IS COMPLETELY FLAT AGAIN. ARE YOU IMPATIENT? :) THEN CAREFULLY PUT A BOOK ON IT.

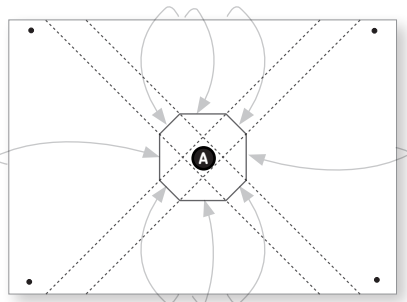

LAY THE UNFOLDED VASE WITH **(A)** FACING UP. DOUBLE THE SHEET AND FOLD (8X), AT THE BACK OF THE VASE, ONLY ON THE BLACKSHADED LINES.

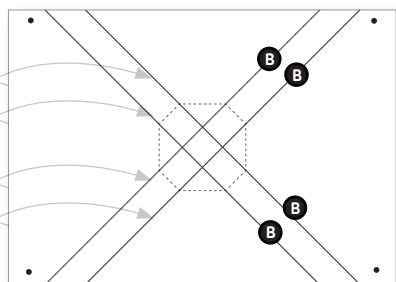

TURN THE SHEET OVER, FOLD THE **(B)** FOUR DIAGONAL LINES, (AT THE BACK OF THE VASE) ON THE INSIDE.

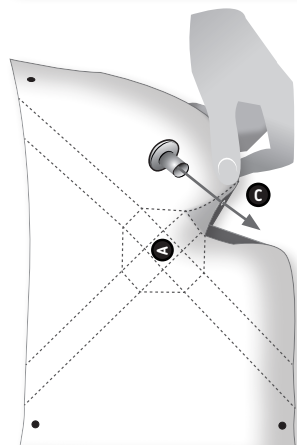

TURN THE SHEET BACK TO **(A)** AND TURN 90°. TAKE THE UPPER RIGHT CORNER BETWEEN YOUR THUMB AND FOREFINGER. INSERT THE SCREW WITH THE HOLLOW SIDE, FROM INSIDE TO OUTSIDE **(C)**. TURN THIS CORNER (CLOCKWISE) 90° INWARDS AND SIMULTANEOUSLY UPWARDS. KEEP THE VASE IN THIS POSITION.

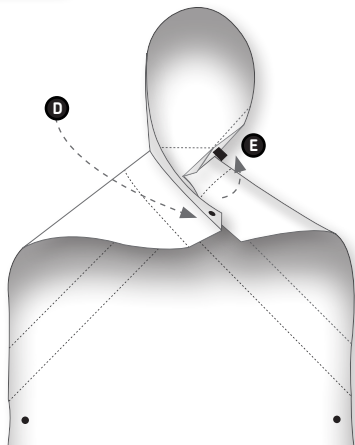

TAKE THE LOWER LEFT CORNER NOW **(D)** WITH YOUR OTHER HAND. TURN THIS CORNER 90° (ANTI-CLOCKWISE) IN AND UP, SO THAT THE HOLE IS EXACTLY IN FRONT OF THE SCREW, (WITH THE HOLLOW SIDE). **(E)** PUSH THE SCREW THROUGH THE HOLE AND KEEP THE VASE IN THIS POSITION.

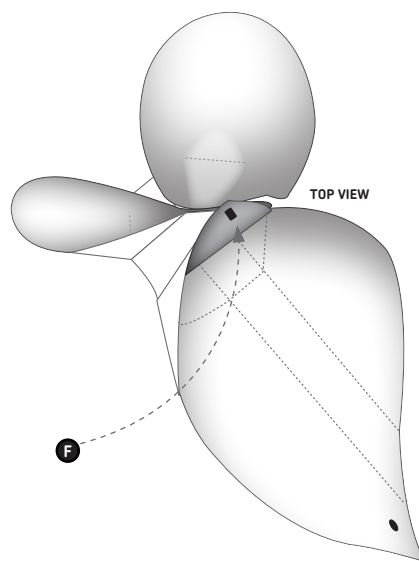

REPEAT THIS STEP IN **(F)**, IN THE SAME WAY AS IN STEP 4, WITH THE LOWER LEFT CORNER OF THE VASE, PUSH THE SCREW THROUGH THE HOLE. HOLD THE VASE IN THIS POSITION AND PROCEED TO STEP 7.

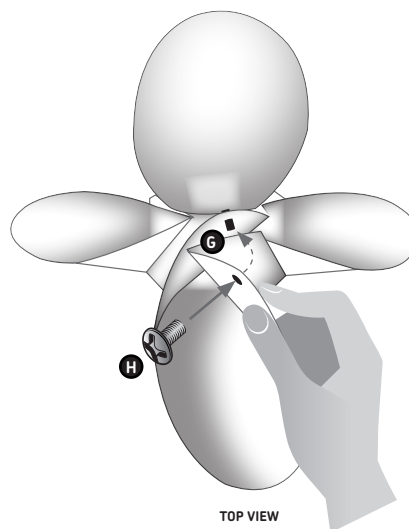

REPEAT THIS STEP **(G)**, IN THE SAME WAY AS IN STEP 5, WITH THE LOWER RIGHT CORNER OF THE VASE, PUSH THE SCREW THROUGH THE HOLE.

H) TIGHTEN THE SCREW BY SCREWING THE OTHER PART OF THE SCREW ONTO IT. IF NECESSARY, PUSH OUT SOME LITTLE DENTS (PUSH FROM THE INSIDE OUT). THE WALL VASE IS READY. MAKE SURE THE VASE IS TIGHTLY CLOSED BEFORE FILLING IT WITH WATER.

HENDRIK.NU ©

TIPS

- FOLD THE VASE ON A FLAT TABLE. PLEASE NOTE OF FOLDING WITH YOUR FINGERS. DO NOT FOLD WITH HARD OBJECTS, THE VASE MAY LEAK.
- READ THE INSTRUCTIONS CAREFULLY EVERY STEP BEFORE YOU START FOLDING. ALSO CHECK THE INSTRUCTION VIDEO ON HENDRIK.NU

CAUTION

THIS FOLDING VASE HAS A MAXIMUM USE GUARANTEE OF 12 MONTHS. THE MATERIAL OF THIS FOLDING VASE WILL BEEASILY DEGRADED UNDER THE INFLUENCE OF SUNLIGHT. IT WILL BEGIN CRACKING LIKE AN EGG SHELL IN THE OUTDOOR AIR AFTER A PERIOD OF 9 TO 12 MONTHS (IF THE VASE IS OUT IN THE SUN FOR TEN HOURS A DAY).

